

# BA800

Portable Rear Hold Down Kit



Customer Service  
(800) 247-7668

PARTS LIST					
Item	Qty	Description	Item	Qty	Description
A	2	Angle Brace	E	4	1/2" Hex Nut
B	2	Hand Knob	F	4	1/2" Lock Washer
C	2	VB25 Anchor (packaged separately)	G	8	1/2" Flat Washer
D	4	1/2" X 1" Hex Bolt			

- ◆ Inspect all contents prior to installation. Report any missing parts to dealer immediately.
- ◆ Read all instructions before proceeding.

**Warning!**  
**It may be necessary to remove some of the ballast material in order to reach the underside of the unit. If so support unit in the front so it will not tip over.**

1. Tip unit forward and support so that you have enough clearance to easily reach the underside rear portion of the base.
2. Use the *1/2" X 1" Hex Bolts (D)*, *1/2" Flat Washers (G)*, *1/2" Lock Washers (F)* and *1/2" Hex Nuts (E)* to attach *Angle Brace (A)* to the base. Leave hardware finger tight. See Figure 1.
3. Set unit back onto the floor and position the bottom of *Angle Braces (A)* approximately 1/4" off the floor, tighten the hardware. See Figure 2.
4. Position the unit so that the back of the base is approximately 2" in front of the *VB25 Anchors (C)*.
5. Insert one *Hand Knob (B)* into each of the slots on the outer edge of *Angle Brace (A)* and tighten. See Figures 1 and 2.
6. *VB25 Anchors (C)* must be installed 44 1/4" behind the baseline and 26" apart for the base to be positioned correctly on the court. See Figure 3.

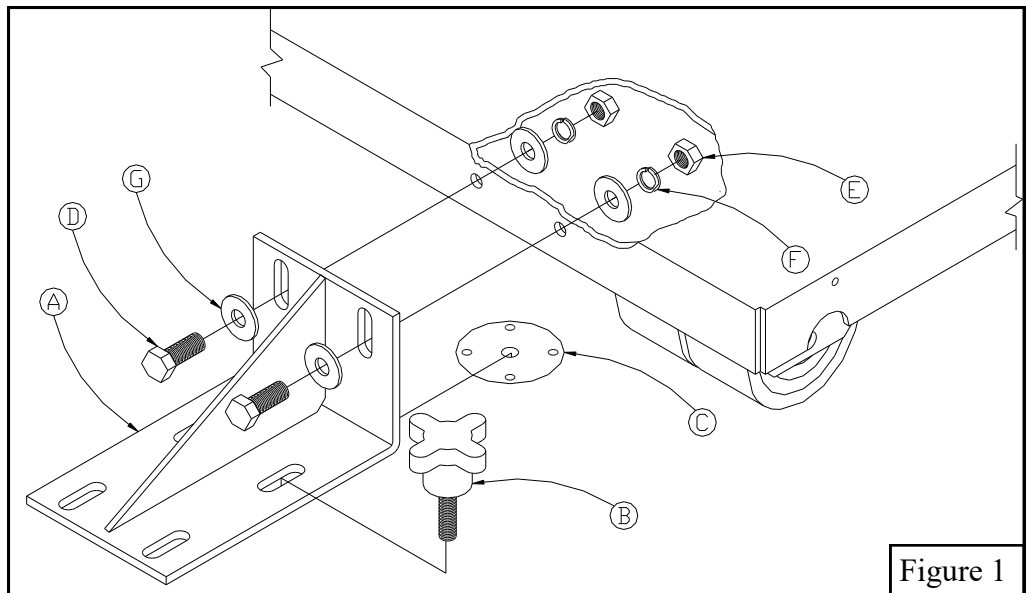

Figure 1

